

**1-1/2 in. 70/30 Copper Nickel Sleeve.
 CL200 Rating, Bell end Connection MSS-
 SP-119**



<u>Item No.</u>	M111424	<u>UOM</u>	EA
-----------------	---------	------------	----

[View Product Online to Request Quote](#)

Specifications

Type	Sleeve
Size	1-1/2 in.
Material	Copper Nickel
Material Grade	70/30 Copper Nickel
Pressure Class	CL200
Connection	Bell end
Specification	MSS-SP-119
Market	Navy

Product URL: <https://torksystems.com/M111424>

Copper Nickel (CuNi) Bell End Sleeves (MSS SP-119)

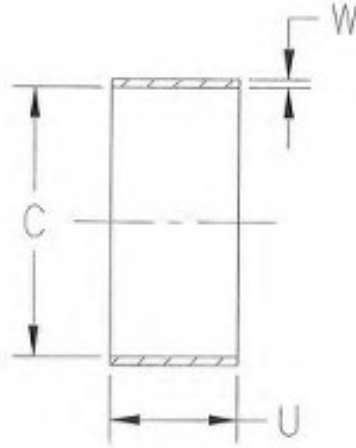

Standard Sleeve

Nominal Pipe Size	C	U	W
1/4	0.57	0.88	0.07
3/8	0.70	0.88	0.07
1/2	0.87	0.88	0.07
3/4	1.08	0.88	0.07
1	1.35	1.00	0.07
1-1/4	1.69	1.12	0.08
1-1/2	1.93	1.36	0.08
2	2.41	1.36	0.09
2-1/2	2.91	1.74	0.09
3	3.53	1.74	0.10
3-1/2	4.00	1.75	0.11
4	4.53	1.88	0.12
5	5.60	2.12	0.14
6	6.66	2.24	0.15
8	8.66	2.74	0.16
10	10.79	3.12	0.20
12	12.79	3.36	0.27