



**3/4 x 1/4 in. 90/10 Copper Nickel Bushing.  
 400 lb Rating, Socket weld Connection,  
 Reducing 803-6397430**

<u>Item No.</u>	M120198	<u>Weight (lb)</u>	0.42
		<u>UOM</u>	EA

[View Product Online to Request Quote](#)

**Specifications**

Type	Bushing
Item Remarks	Reducing
Size	3/4 x 1/4 in.
Material	Copper Nickel
Material Grade	90/10 Copper Nickel
Pressure Class	400 lb
Connection	Socket weld
Specification	
NAVSEA Dwg.	803-6397430
Compare to	640157.147
Market	Navy

Product URL: <https://torksystems.com/M120198>

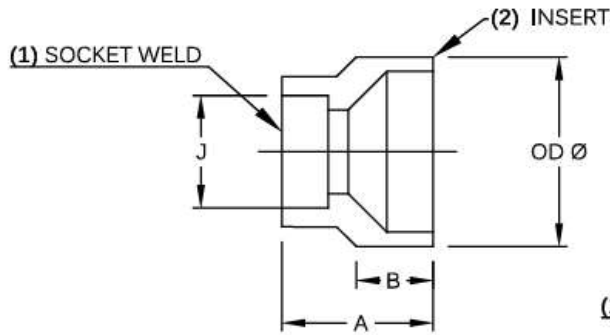

**TYPE 1**

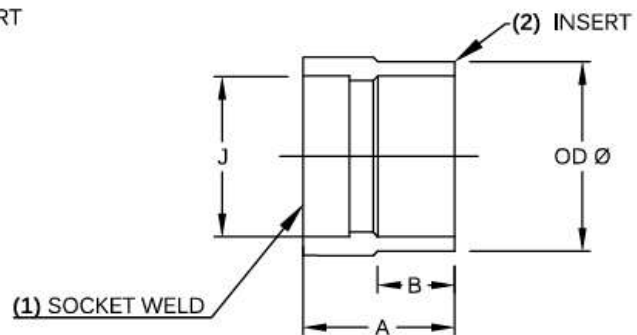

**TYPE 2**

SERVICE RATING (1/4 TO 6 NPS)		
	PRESSURE (MAX)	TEMPERATURE (MAX)
AIR, OIL OR WATER	400 PSI	150 DEG. F
STEAM	200 PSI	425 DEG. F

NPS (SOCKET) (1)	NPS (INSERT) (2)	INSERT TYPE	A	B	OD Ø	J	WEIGHT LBS
1/4	1/2	1	1.06	0.50	0.840	0.545	0.11
1/4	3/4	1	1.06	0.53	1.050	0.545	0.17
1/2	3/4	2	1.19	0.53	1.050	0.845	0.17
1/4	1	1	1.23	0.56	1.315	0.545	0.27
1/2	1	1	1.16	0.56	1.315	0.845	0.27
3/4	1	2	1.25	0.56	1.315	1.055	0.27
1/4	1-1/4	1	1.46	0.63	1.660	0.545	0.27
1/2	1-1/4	1	1.40	0.63	1.660	0.845	0.31
3/4	1-1/4	1	1.33	0.63	1.660	1.055	0.46
1	1-1/4	2	1.44	0.63	1.660	1.320	0.39
1/4	1-1/2	1	1.71	0.75	1.900	0.545	0.66
1/2	1-1/2	1	1.64	0.75	1.900	0.845	0.65
3/4	1-1/2	1	1.58	0.75	1.900	1.055	0.68
1	1-1/2	1	1.47	0.75	1.900	1.320	0.65
1-1/4	1-1/2	2	1.63	0.75	1.900	1.665	0.58
1/4	2	1	1.97	0.78	2.375	0.545	0.63
1/2	2	1	1.91	0.78	2.375	0.845	1.14
3/4	2	1	1.85	0.78	2.375	1.055	1.21
1	2	1	1.74	0.78	2.375	1.320	1.06
1-1/4	2	1	1.63	0.78	2.375	1.665	0.97
1-1/2	2	1	1.64	0.78	2.375	1.905	0.91

**NOTES:**

- 1) ALL DIMENSIONS ARE IN INCHES.
- 2) DIMENSIONS ARE PER NAVSEA DWG. 803-6397430 & MIL-F-1183
- 3) THIS STANDARD INTENDED FOR USE WITH CLASS 200 OR CLASS 700 CUNI IN ACCORDANCE WITH MIL-T-16420.